



5599 Highway 31 West
Portland, TN 37148
(800) 222-4393

P-120

Pg.1 . TITLE PAGE

Pg.3 . P-120 BOM

Pg.2 . P-120 EXPLODED

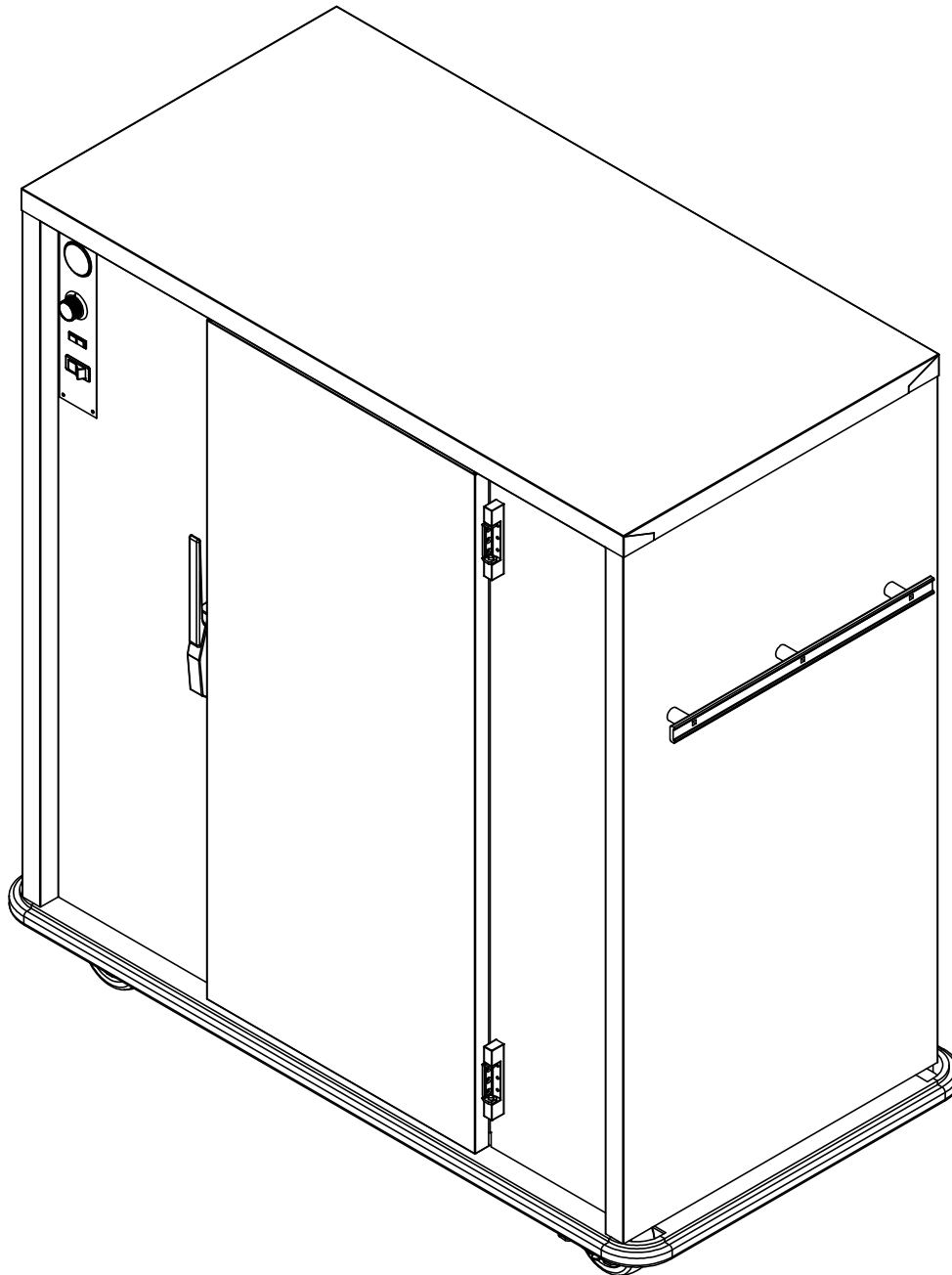

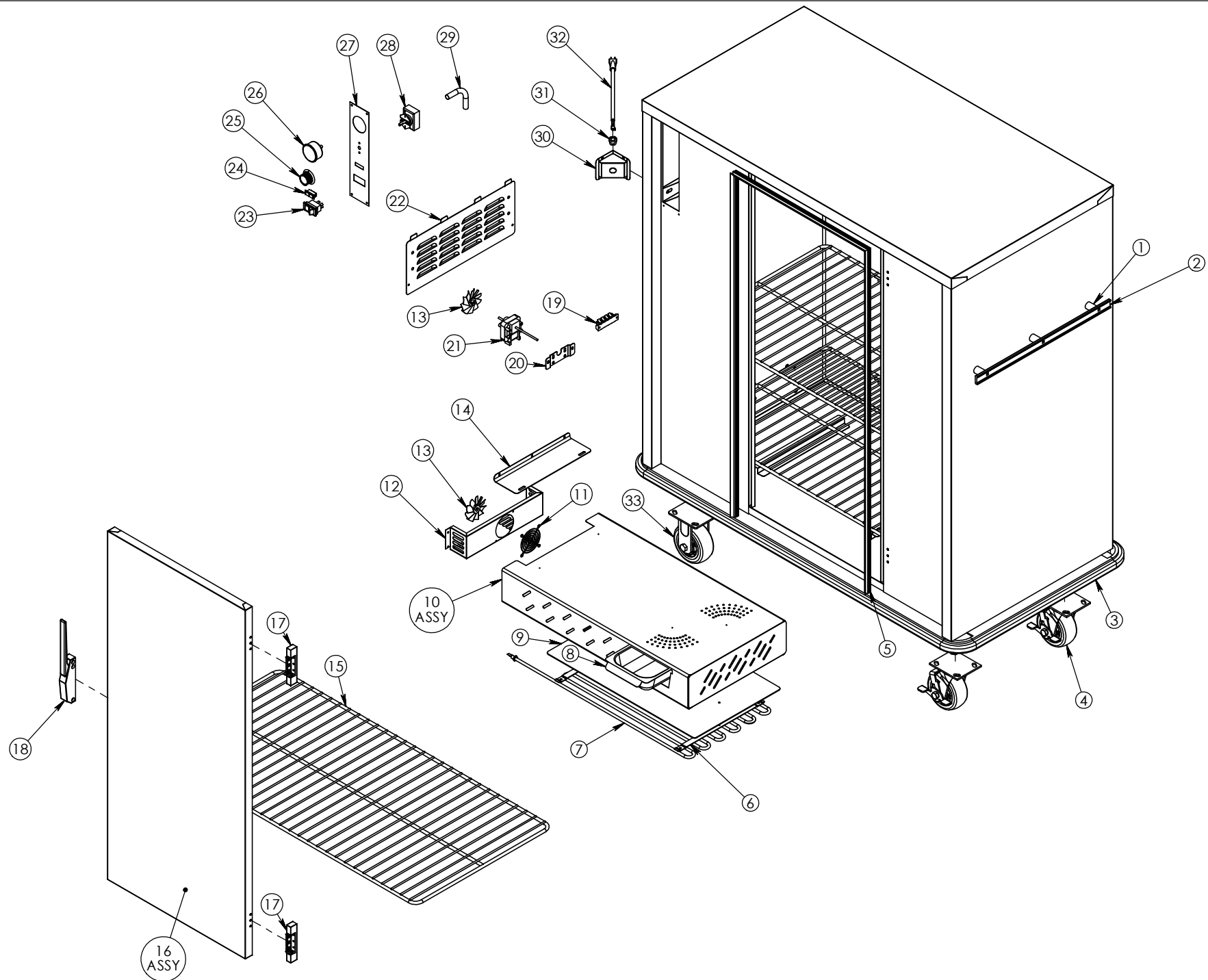

DRAWING #: P-120	
DESCRIPTION: BANQUET CABINETS - P SERIES	
DRAWN BY: DP	LAST SAVED BY: dplodzien

ITEM NO.	QTY.	PART NO.	DESCRIPTION
1	6	SPCR125X.330	HANDLE SPACERS FOR HDL 21 AND 12.
2	2	HDL-215-AL	HANDLE PUSH AL 21.5
3	1	Z-200-1002	BUMPER
4	2	CSTR 52-SB-PPF	CASTER 5" SWIVEL BRAKE EZ ROLL POLY
5	1	GSKT-D-48-062X21-812	SILICONE DR GASKET D 48.062X21.812
6	1	5958	1600W ELEMENT BRACKET STRAP
7	1	EL1600-120HT-XL-28	ELEMENT 1600 WATT 120 VOLT 28" HT
8	1	WATER-PAN-3RD-WHDL	WATER PAN 2.5" X6.75 X
9	1	50300	ALUM HTNG ELEMENT CVR
10	1	Z-600-1241 (INCLUDES 8)	P-200 WATER PAN TUNNEL ASSEMBLY
11	1	GRD FAN	FAN GUARD
12	1	5345	HUMITEMP BLOWER HSING
13	2	BLD FAN AL	FAN BLADE 3" ALUMINUM
14	1	4041	HUMITEMP BLOWER LID
15	3	SHLF-P120	SHELF 22.25X44.25"
16	1	Z-301-3960 (INCLUDES 17,18)	P-120 DR ASMBLY EDG/EDG RH P I
17	2	HNG-214	DOOR HINGE EDGEMOUNT .875"
18	1	LTH-DR	DOOR LATCH EDGEMOUNT STYLE CHROME
19	1	TRM 4QC	TERMINAL BLOCK 4QC
20	1	80610	BRACKET MOTOR MNT FOR BAY MTR
21	1	MTR BY120 92	MOTOR DUAL SHAFTED 120 VOLT
22	1	53454	HUMITEMP LOUVER PANEL W/TABS
23	1	SWH RCK E1	SWITCH NON-LT ROCKER 125/250V 20AMP
24	1	LT PLT A-G	INDICATOR LIGHT AMBER GREEN 125V
25	1	KNB H6	KNOB WITH ARROW
26	1	T-METER H1	THERMOMETER 100-220
27	1	CNTRL-PNL-HUMI-TEMP-AL	ALUM PANEL FOR HUMI-TEMP
28	1	T-STAT H1	THERMOMSTAT HEAT CONTRL 90-190
29	1	SLV-ACRYLIC-WHITE-7-16	SLEEVING ACRYLIC 7/16 ID WHITE FA1
30	1	69729	HUMI TRI-CORD BRCKET DD .672X .750
31	1	BSH STRN 3	STRAIN RELIEF FOR 15 AMP CORD
32	1	CRDSET10-115	CORD 12' 115V 5-15P 14GA 3WR 15AMP
33	1	CSTR 52-R-PPF	CASTER 5" RIGID EZ ROLL POLY

DRAWING #: **P-120**

DESCRIPTION: **BANQUET CABINETS - P SERIES**

DRAWN BY: DP

LAST SAVED BY: dplodzien