



5599 Highway 31 West  
Portland, TN 37148  
(615)325-2774

# UHS-4

Pg.1 .....Title Page

Pg.3 .....UHS-4  
BOM

Pg.2 .....UHS-4

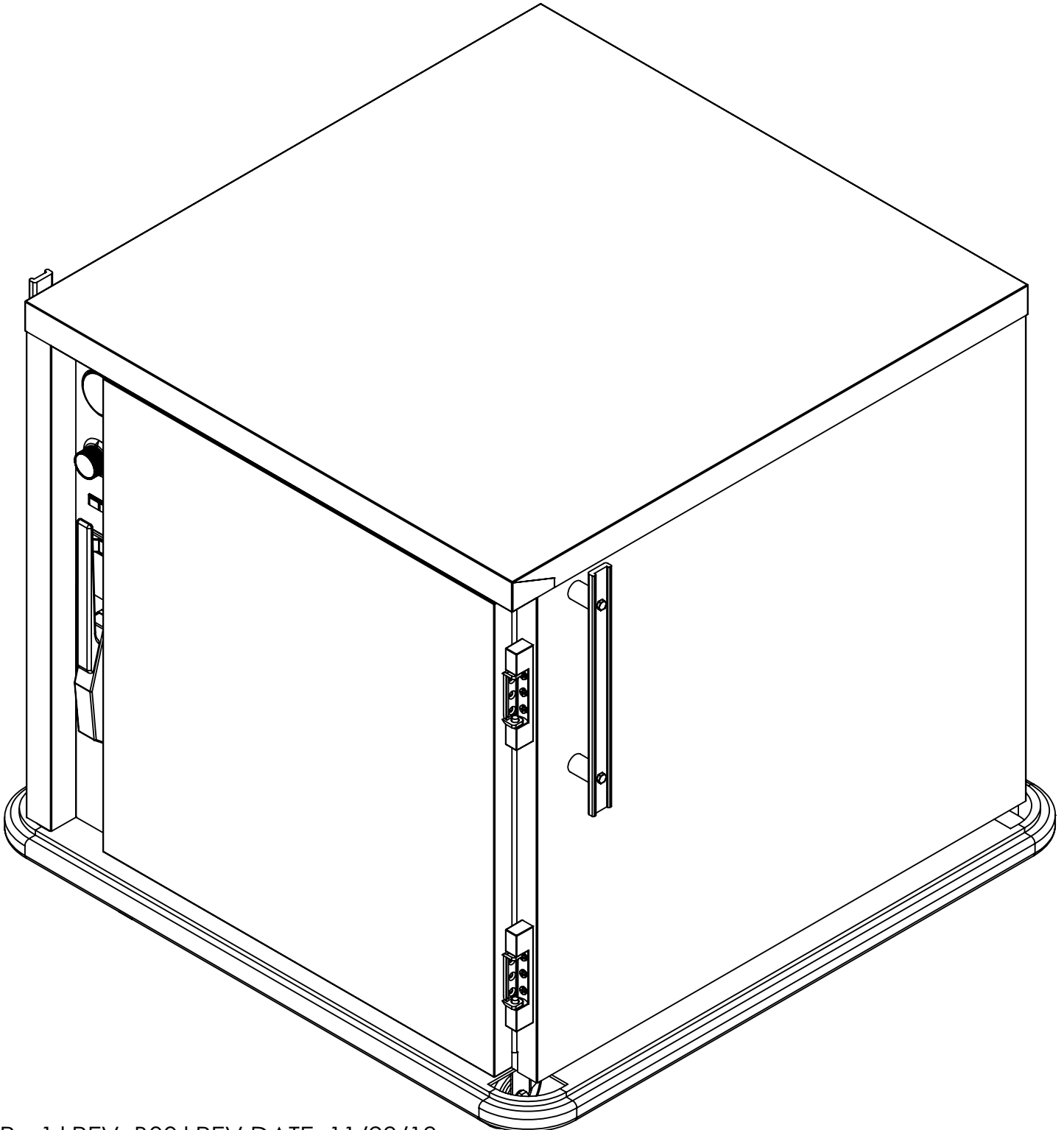

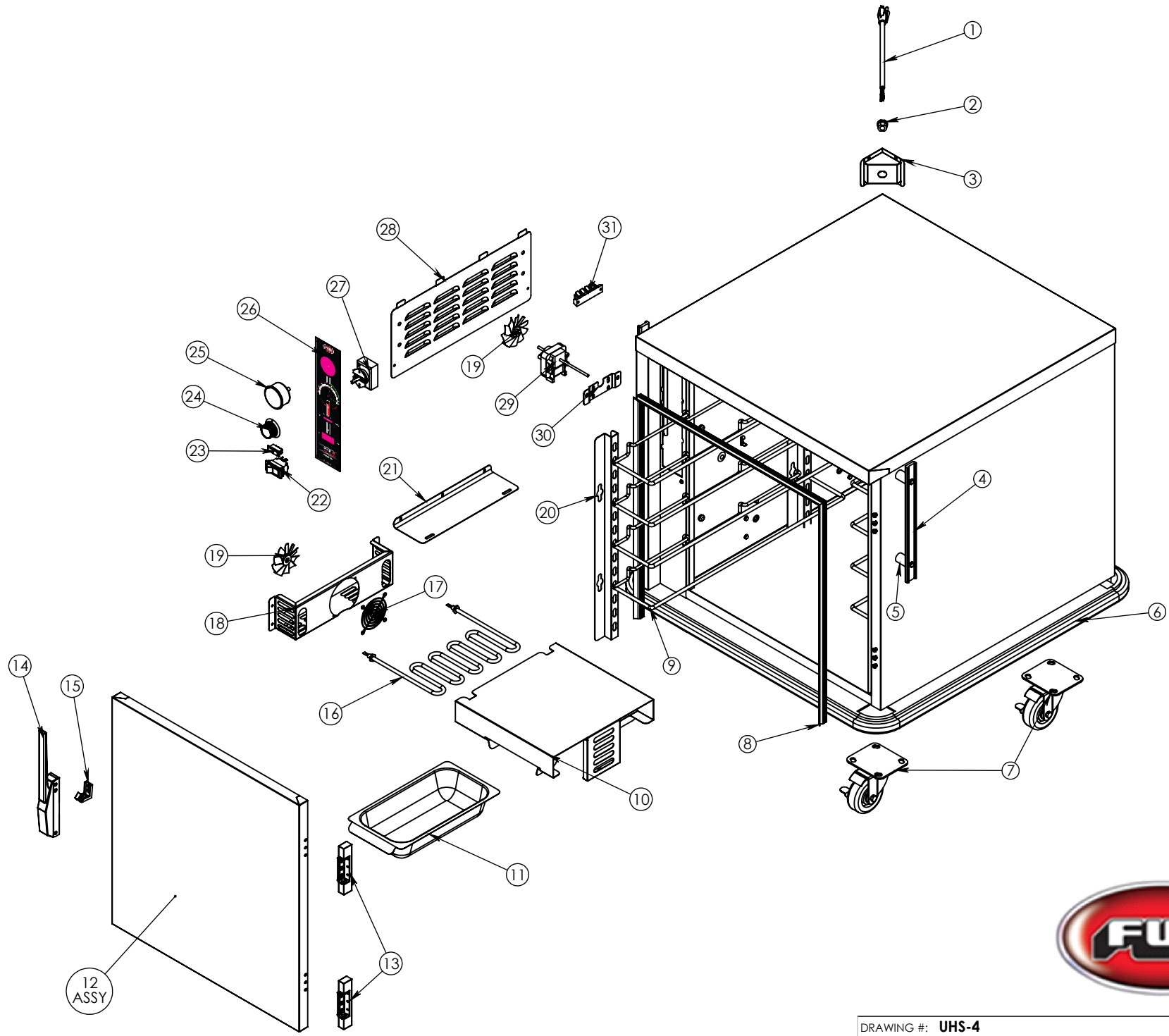

DRAWING #: <b>UHS-4</b>	
DESCRIPTION: <b>UNIVERSAL SERVER</b>	
DRAWN BY: PABLO	LAST SAVED BY: andrew82

ITEM NO.	QTY.	PART NO.	DESCRIPTION
1	1	CRDSET10-115	CORD 12' 115V 5-15P 14GA 3WR 15AMP
2	1	BSH STRN 3	STRAIN RELIEF FOR 15 AMP CORD
3	1	69729	HUMI TRI-CORD BRCKET DD .672X .750
4	2	HDL-125-AL	HANDLE PUSH ALUMINUM 12.5" LONG
5	4	SPCR125X.330	HANDLE SPACERS FOR HDL 21 AND 12.
6	1	Z-200-1564	UHS BUMPER ASSY
7	4	CSTR 3.5 SB-5	CASTER 3.5" SWIVEL BRAKE HEAVY DUTY
8	1	GSKT-D-24X23-375	SILICONE DOOR GASKET D 24X23.375
9	8	SLD UHS245	TRAY SLIDE NICKEL PLATED UHS
10	1	58408	UHS HEAT SHIELD USE WITH H20 PAN
11	1	WATER-PAN-3RD-WHDL	WATER PAN 2.5" X6.75 X
12	1	Z-301-3927 ( INCLUDES 13, 14 & 15 )	UHS-4 DOOR ASSY EDG/EDG RH
13	2	HNG-214	DOOR HINGE EDGEMOUNT .875"
14	1	LTH-DR	DOOR LATCH EDGEMOUNT STYLE CHROME
15	1	STK LTH 1	DOOR LATCH STRIKE FOR LTH DR
16	1	EL1250-120-HT	ELEMENT 1250 WATT 120 VOLT 8" HT
17	1	GRD FAN	FAN GUARD
18	1	4011	HUMITEMP BLOWER HOUSING
19	2	BLD FAN AL	FAN BLADE 3" ALUMINUM
20	4	4003	UHS-4 UPRIGHT
21	1	4041	HUMITEMP BLOWER LID
22	1	SWH RCK E1	SWITCH NON-LT ROCKER 125/250V 20AMP
23	1	LT PLT A-G	INDICATOR LIGHT AMBER GREEN 125V
24	1	KNB H6	KNOB WITH ARROW
25	1	T-METER H1	THERMOMETER 100-220
26	1	CNTRL-PNL-HUMI-TEMP-AL	ALUM PANEL FOR HUMI-TEMP
27	1	T-STAT H1	THERMOMSTAT HEAT CONTRL 90-190 36"
28	1	53454	HUMITEMP LOUVER PANEL W/TABS
29	1	MTR BY120 92	MOTOR DUAL SHAFTED 120 VOLT
30	1	80610	BRACKET MOTOR MNT FOR BAY MTR
31	1	TRM 4QC	TERMINAL BLOCK 4QC



DRAWING #: **UHS-4**

DESCRIPTION: **UNIVERSAL SERVER**

DRAWN BY: andrew82

LAST SAVED BY: andrew82