



5599 Highway 31 West
Portland, TN 37148
(615)325-2774

UHS-BQ-120-XL

Pg.1TITLE PAGE Pg.3UHS-BQ-120-XL BOM

Pg.2UHS-BQ-120-XL

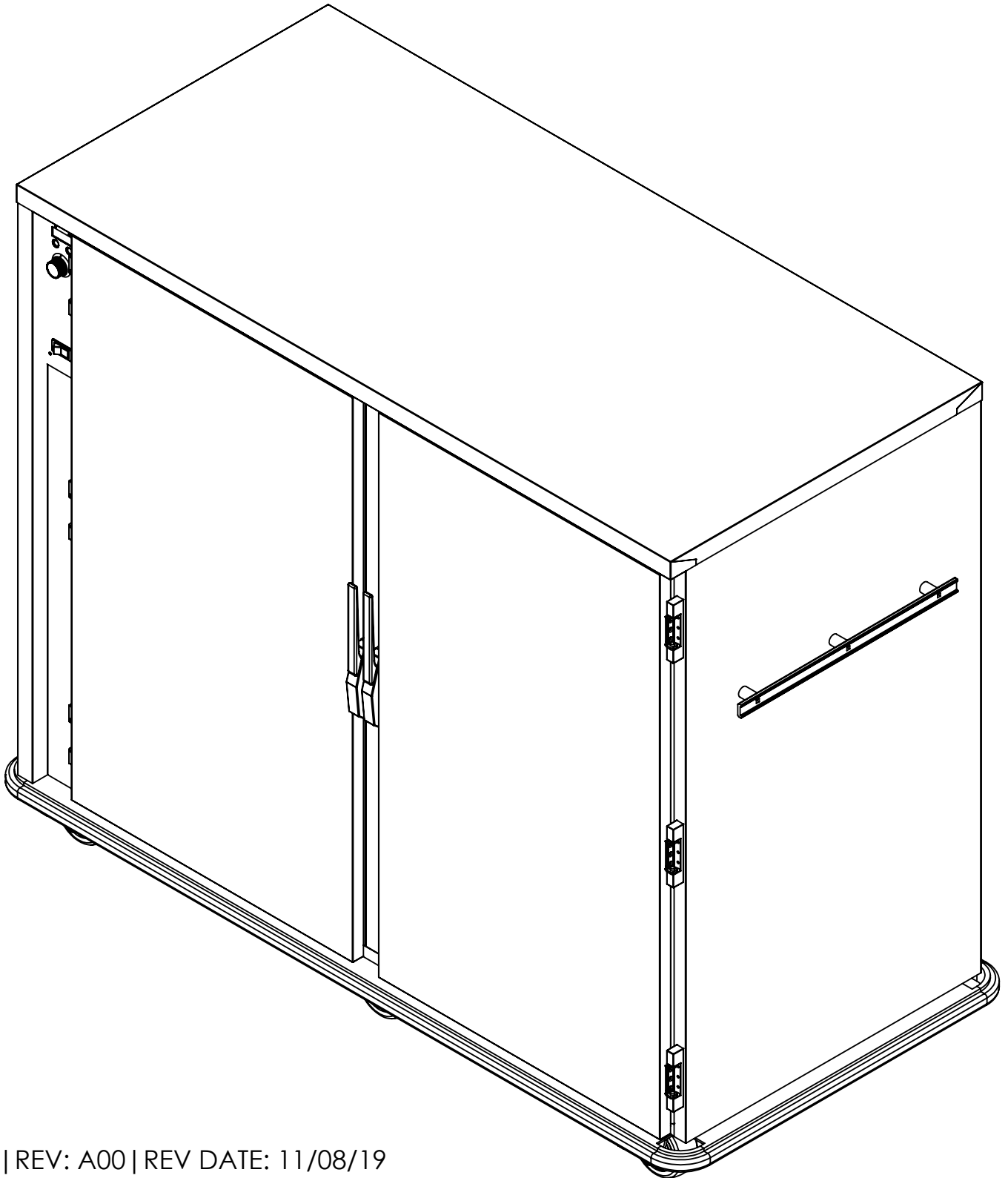

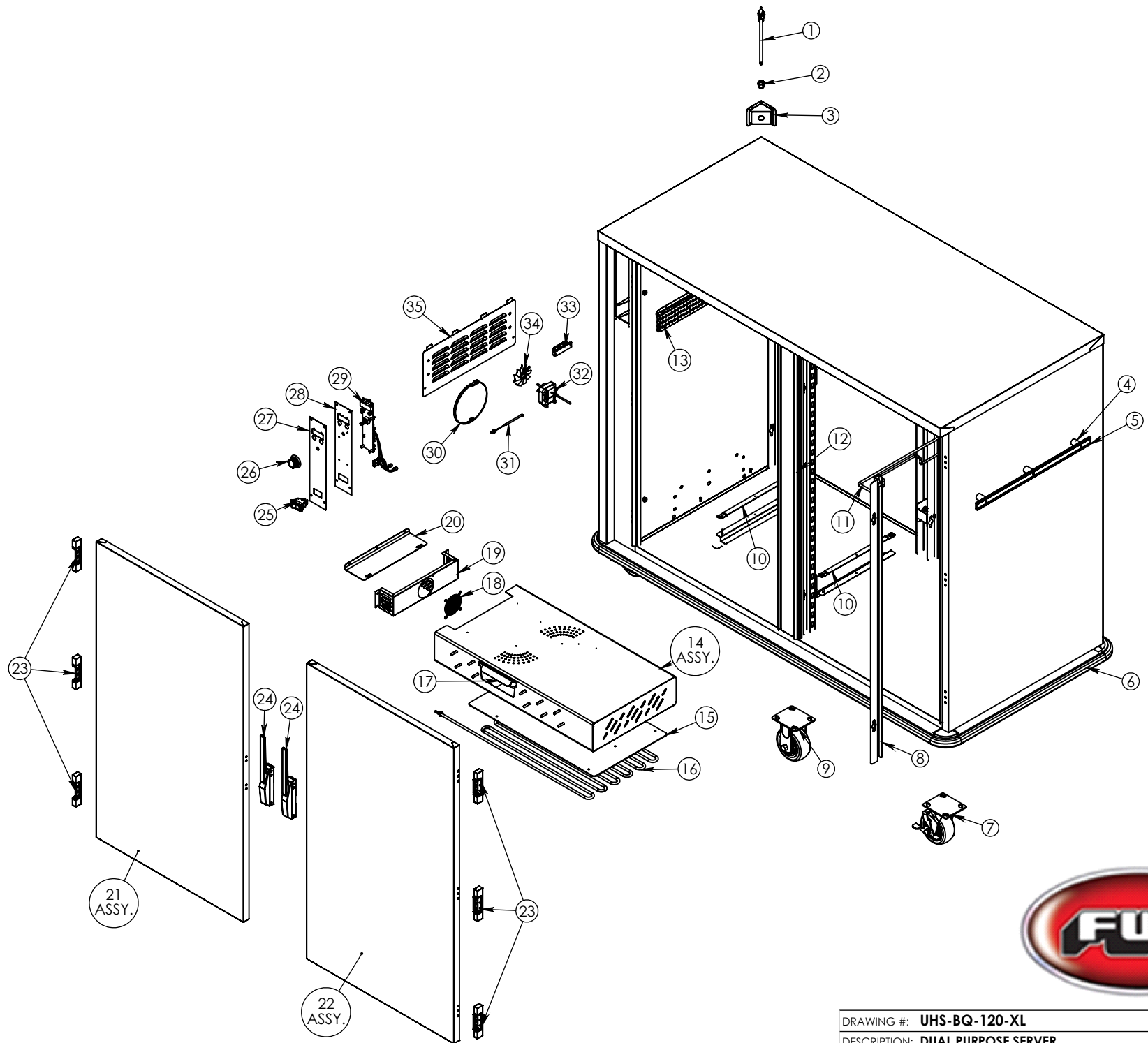

DRAWING #: **UHS-BQ-120-XL**

DESCRIPTION: **DUAL PURPOSE SERVER**

DRAWN BY: A. LINCOLN | LAST SAVED BY: andrew82

ITEM NO.	QTY.	PART NO.	DESCRIPTION
1	1	CRDSET10-115	CORD 12' 115V 5-15P 14GA 3WR 15AMP
2	1	BSH STRN 3	STRAIN RELIEF FOR 15 AMP CORD
3	1	69729	HUMI TRI-CORD BRCKET DD .672X .750
4	6	SPCR125X.330	HANDLE SPACERS FOR HDL 21 AND 12.
5	2	HDL-215-AL	HANDLE PUSH AL 21.5
6	1	Z-200-1153	UHS-BQ-120-XL BUMPER ASSEMBLY
7	4	CSTR 52-SB-PPF	CASTER 5" SWIVEL BRAKE EZ ROLL POLY
8	4	142317	UHS-BQ-120-XL UPRIGHT
9	2	CSTR 52-R-PPF	CASTER 5" RIGID EZ ROLL POLY
10	2	5958	1600W ELEMENT BRACKET STRAP
11	36	SLD TS245	TRAY SLIDE NICKEL PLATED 18X26
12	2	GSKT-D-48-000X27-770	SILICONE DOOR GASKET D 48X27.77
13	1	5240	THERMOSTAT CAPILLARY GUARD
14	1	Z-600-1252 (INCLUDE PART 17)	WATER PAN TUNNEL ASSEMBLY
15	1	50300	UHS-BQ-120XL ALUM HTNG ELEMENT CVR
16	1	EL1600-120HT-XL-28	ELEMENT 1600 WATT 120 VOLT 28" HT
17	1	WATER-PAN-3RD-WHDL	WATER PAN 2.5" X6.75 X
18	1	GRD FAN	FAN GUARD
19	1	5345	HUMITEMP BLOWER HSING
20	1	4041	HUMITEMP BLOWER LID
21	1	Z-301-4476 (INCLUDE PART 23 AND 24)	UHS-BQ-120-XL DOOR EDG/EDG 3HNG LH
22	1	Z-301-4477 (INCLUDE PART 23 AND 24)	UHS-BQ-120-XL DOOR EDG/EDG 3HNG RH
23	6	HNG-214	DOOR HINGE EDGEMOUNT .875"
24	4	LTH-DR	DOOR LATCH EDGEMOUNT STYLE CHROME
25	1	SWH RCK E1	SWITCH NON-LT ROCKER 125/250V 20AMP
26	1	KNB H6	KNOB WITH ARROW
27	1	CNTRL PNL T-STAT V-G	OVERLAY, HUMI-TEMP IEC VERTICAL
28	1	81388	ELECTRONIC T-STAT RCK E1 SWITCH
29	1	T-STAT ELE 2	ELEC THERMO HEAT CNTRL VERTICAL IEC
30	1	PRB HARNESS 36	36" PROBE HARNESS - TSTAT ELE
31	1	PRB RTD T	RTD TEMPERATURE PROBE FOR T-STAT
32	1	Z-600-6151	MOTOR DUAL SHAFTED 120 VOLT
33	1	TRM 4QC	TERMINAL BLOCK 4QC
34	2	BLD FAN AL	FAN BLADE 3" ALUMINUM
35	1	53454	HUMITEMP LOUVER PANEL W/TABS



DRAWING #: **UHS-BQ-120-XL**

DESCRIPTION: **DUAL PURPOSE SERVER**

DRAWN BY: A.LINCOLN

LAST SAVED BY: andrew82