

PROOFER & HEATED HOLDING CABINETS

Non-Insulated – For Full Size and Half Size Sheet Pans

TEMP SET RANGE: 90° – 190°F (32° – 88°C) 

NON-INSULATED PROOFER/HEATER "ETC-1826-PH" SERIES

Two cabinets in one! Dual-purpose cabinets proof and heat, eliminating costly duplication of equipment



- 1** User-friendly mechanical control panel has separate air moisture and air temperature controls, and includes steam deflector shield to protect controls from moisture damage
- 2** Humidity system with separately controlled moisture and heat settings enables the user to create high humidity with low heat output - an ideal environment for proofing
- 3** Removable humidity pan: 12" x 20" pan provides large water reservoir - removable, easy to clean and replaceable
- 4** ETC-1826-PH series accommodates 18" x 26" and 14" x 18" trays. Fixed lip-loader rack is one piece, die stamped aluminum, and removable for easy cleaning
- 5** Field reversible door - flexible installation options for kitchen layout
- 6** Easy to maneuver - FWE cabinets are constructed with durable, maintenance-free casters designed to easily move around your space and lock into place
- 7** Magnetic workflow door handle - ergonomically accommodates kitchen staff and servers at varying heights
- 8** Sloped inside top directs condensation towards the back of the cabinet, preventing drips onto product

****Two year limited warranty***



Control Panel

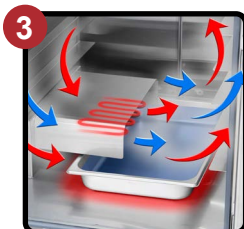

Humidity Pan



Lip-Loader Fixed Rack



Magnetic Work Flow Door Handle

PROOFER  HEATER

SPECIFICATIONS

PROOFER & HEATED HOLDING CABINETS

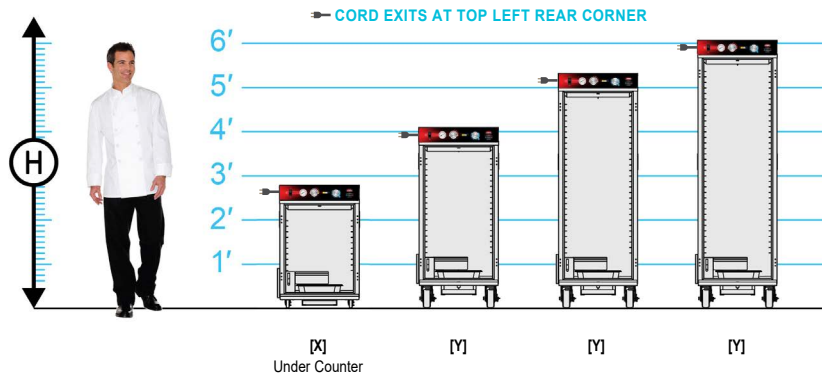

| ELECTRICAL DATA | | | |
|-----------------|--------|--------|---------|
| ▼ STANDARD | | | |
| VOLTS | 120 | 208 | 220-240 |
| WATTS | 1900 | 1830 | 2430 |
| AMPS | 15.8 | 8.8 | 10.1 |
| HERTZ | 50/60 | 50/60 | 50/60 |
| PHASE | Single | Single | Single |
| PLUG USA | 5-20P | 6-15P | 6-15P |
| PLUG CANADA | 5-20P | 6-15P | 6-15P |

▼ Lowest voltage shown is standard.

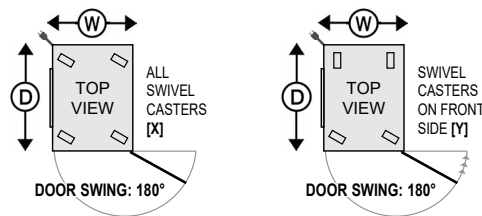

| CAPACITIES OF TRAYS / PANS: 1.5" (38mm) Spacings Are Standard [A] | | | | | | | | | | CLASS 100 | | |
|---|--|-----------|---|-----------|-----------|--------|--|--------------|-------------|--------------|---------------|--------------------|
| MODEL NUMBER | STANDARD FIXED RACK @ 1.5" Spacings (38mm) [A] | | OPTIONAL ADJUSTABLE SLIDES @ 3" Spacings (76mm) [B] | | | | OVERALL EXTERIOR DIMENSIONS IN. (mm) (Height Includes Casters) | | | NO. OF DOORS | CASTER SIZE | SHIP WT. LBS. (KG) |
| | 18 x 26 | 14 x 18 | 18 x 26 | 14 x 18 | 12 x 20 | GN 1/1 | HIGH "H" | DEEP "D" | WIDE "W" | | | |
| | 18" x 26" | 14" x 18" | 18" x 26" | 14" x 18" | 12" x 20" | GN 1/1 | (457) | (813) | (572) | | | |
| Under Counter | 10 | 20 | 5 | 10 | 5 | 5 | 33.25" (845) | 32.75" (832) | 22.5" (572) | 1 | 2" ALL SWIVEL | 205 (93) |
| | 18 | 36 | 9 | 18 | 9 | 9 | 49" (1245) | 32.75" (832) | 22.5" (572) | 1 | 5" | 260 (118) |
| | 28 | 56 | 14 | 28 | 14 | 14 | 64" (1626) | 32.75" (832) | 22.5" (572) | 1 | 5" | 290 (132) |
| | 34 | 68 | 17 | 34 | 17 | 17 | 73" (1855) | 32.75" (832) | 22.5" (572) | 1 | 5" | 310 (141) |

[A] Fixed slides accommodate: one (1) 18" x 26", or two (2) 14" x 18" trays/pans. Number of tray slides are listed above. Standard spacings are 1.5" (38mm).

[B] Optional adjustable tray slides accommodate: one (1) 18" x 26", two (2) 14" x 18", one (1) 12" x 20", and one (1) GN 1/1 containers. Uprights punched on 1.5" (38mm) centers.

ETC-1826-PH models are available with: See-thru Lexan Door [add "L"] Dutch Doors [add "D"] Note: Dutch Doors are 2 half size doors only available on full-size models.

CONSTRUCTION. Heliarc welded, single unit construction; 20 gauge polished stainless steel exterior, 22 gauge stainless steel inside bottom. Inside top shall be sloped to direct condensation to the rear of the unit.

HANDLES. Full-size, form-fitting recessed hand grips shall be mounted on each side of cabinet.

DOORS AND LATCHES. Flush mounted, field reversible, stainless steel insulated doors. High temperature gasket sealed; gasket shall be cabinet mounted. Magnetic work flow door handle shall be full length, vertical, and positive closing. ETC-1826-IOPH is standard with horizontal work flow handle. Each door shall have two (2) heavy-duty edgmount die cast hinges. The hinge and latch mountings are reinforced with stainless steel backing plates.

CASTERS. Maintenance free polyurethane tire casters in a configuration of two (2) rigid and two (2) swivel with brake. ETC-1826-IOPH model shall be standard with a caster configuration of four (4) swivel with brake. Casters shall have a reinforced yoke mounted to 10 gauge caster plate. The caster mounting plate shall be secured to a 10 gauge stainless steel reinforcing stress plate via welded in place stainless steel studs. The reinforcing stress plates shall be welded to the heavy gauge tubular frame of the unit.

STANDARD FIXED RACK. Removable pair of one piece aluminum lip-loader racks with fixed spacing of 1.5" between pan slides. Each pan slide accommodates one (1) 18" x 26" or two (2) 14" x 18". One piece rack is easy to remove without the use of tools for cleaning.

OPTIONAL ADJUSTABLE SPACINGS.

Welded rod-style tray slides are stainless steel for greater durability and sanitation. Fully adjustable / removable and designed to give secure bottom tray support. Removable stainless steel uprights shall be punched on 1.5" (38mm) spacings for easy tray adjustment, and shall easily lift off heavy-duty stainless steel brackets without the use of tools for cleaning.

PROOFING SYSTEM/CONTROLS. Built in humidified holding system shall include two (2) separate long life Incoloy nickel-chromium alloy heating elements per cavity; separate, adjustable controls shall be provided for each function. One to control the interior air temperature, and one to control the interior air moisture. An oversized stainless steel water reservoir shall be removable for ease of cleaning/sanitation. System shall have a Hi-Temp, self-lubricated, impedance

protected fan-cooled blower motor for moist air distribution. Controls shall be up-front, recessed and shall include a full range thermostat adjustable to actual temperature. Thermostat shall include temperature scale marked in ten degree increments (F/C) from 90° to 190°F (32° to 88°C). An operational range thermometer, adjustable moisture control (Low to High) with "P" to indicate "Proof" position, 20 amp ON/OFF power switch, humidity cycle light, and thermostat cycling light shall also be included.

ELECTRICAL CHARACTERISTICS. 3 wire grounded tri-directional power cord and plug, rear mounted for safety. See electrical data chart above for amperage and receptacle configuration. See electrical chart for models that require a dedicated circuit.

INSTALLATION. Unit should not be installed in an area where adverse environmental conditions are present.

ELECTRICAL

220 volt, 50/60 Hz, single phase
Element upgrade
Electronic controls
Mechanical timer

DOORS

Key locking door latch
Dutch doors
Left hand door hinging
See-thru Lexan doors
Glass doors

SPACINGS

Uprights and adjustable tray slides (option available at no additional cost)
Shelves
Custom rack spacings

CASTERS

All swivel casters
Larger casters

EXTRAS

Reinforced top (consult factory)